

Wall Mounted Backrest

INTENDED USAGE:

The Wall Backrest Profilo is a complementary accessory for the PR-WS-PP-B (PR-WS-PP-BX), PRC-WS-E-B and PR-WSS-PP-B (PR-WSS-PP-BX) Wall Seats and the PR-WSL-PP-B (PR-WSL-PP-BX) and PRC-WSL-E-B Wall Seats with Legs. It works as a back support on which the user can rest while using the wall seat, making it more comfortable and cosy.

INDICATIONS AND CONTRAINDICATIONS:

The Wall Backrest Profilo is aimed to elderly people, wheelchair users, people with reduced mobility of lumbar, knee or hip, and to all those who may need further help and support while using the wall seats. The user is required to have autonomy of balance during the sitting and standing procedures as well as to have adequate ability to keep sitting. The wall backrest must not be used if the user has problems related to balance or perception disorders.

SAFETY WARNING AND INDICATIONS:

- Before every use, be sure the wall backrest is correctly assembled.
- During assembly, strictly adhere to what is shown in the User Manual.
- The risk of finger injuries may increase during the mounting process.
- Do not modify the wall backrest and its components in any way.
- Do not use the wall backrest if damaged or altered in any way. Cracks and deformations may strongly affect the performances and safety of the device.
- Do not use the wall backrest for a different purpose from the intended one.
- The wall backrest must not be stored outdoors.

MAINTENANCE INFO:

The products maintenance consists of the cleaning and sanitation procedures. In order to guarantee a safe use and adequate standard of hygiene, the user should perform these procedures before every use.

The user has to make certain of the structural integrity of the device and its components. For cleaning and sanitation procedures, follow the steps below:

1. Gloves should be worn.
2. Remove the evident dirt before to proceed with the most accurate disinfection.
3. Use water or non aggressive detergent for the cleaning procedure.
4. Wipe with a dry and clean cloth.

REUSE REQUIREMENTS:

The product is suitable for reuse by other users. Before reuse by others, the product must be correctly cleaned and sanitized. Before the transfer of the product to others, the product must be checked by qualified dealers.

CORRECT DISPOSAL PROCEDURE:

Do not dispose of the product in the normal household waste. Ask your local authority beforehand for the correct and environmentally friendly way to dispose it.

INCIDENT REPORTING:

If there was a serious incident involving this device, contact the manufacturer of this product at info@kdesign-group.com and the responsible authority in your country.

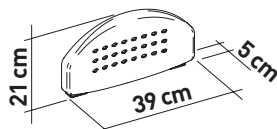

Wall Mounted Backrest

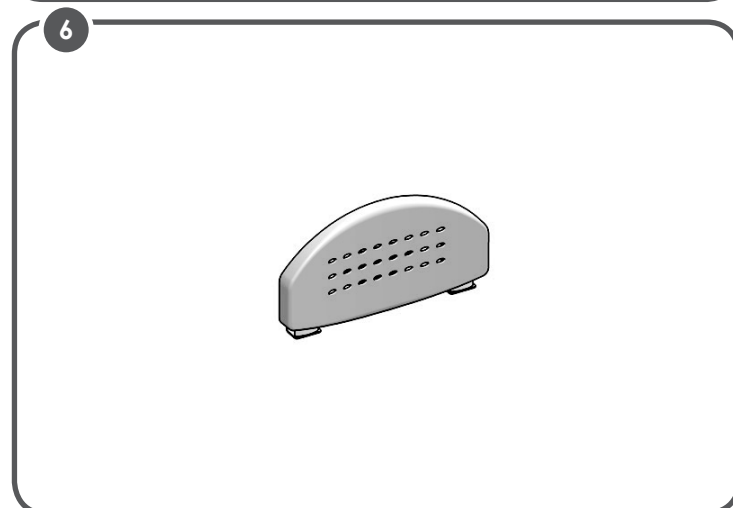
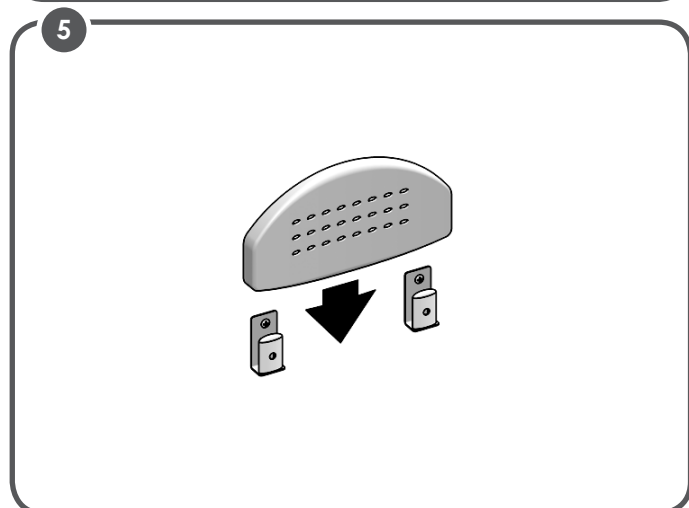
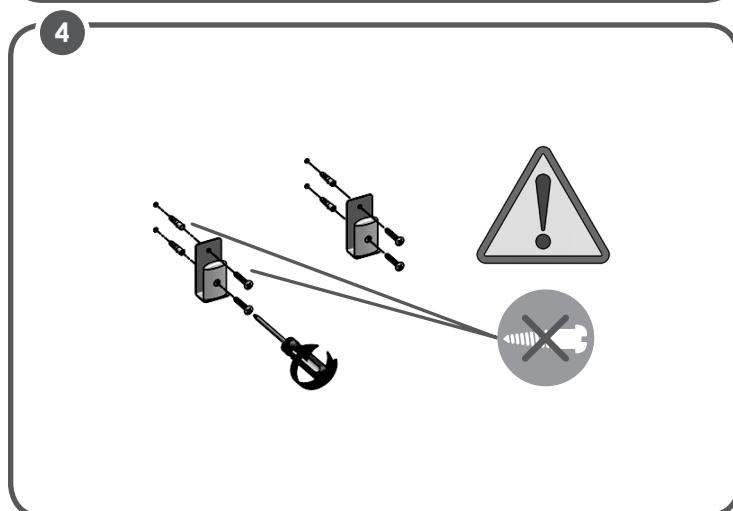
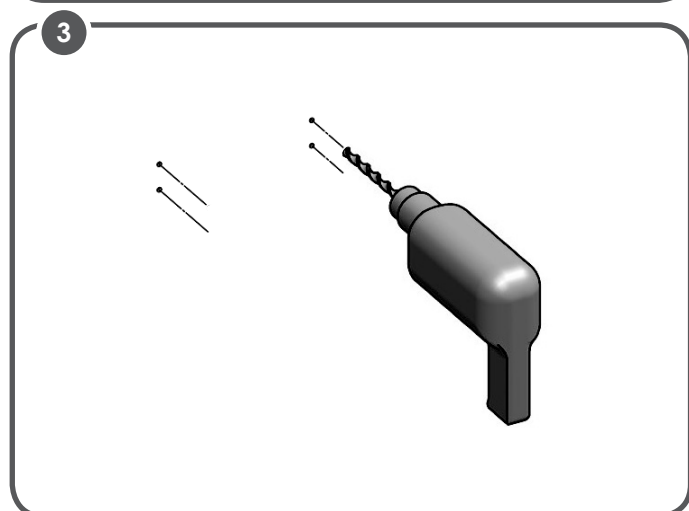
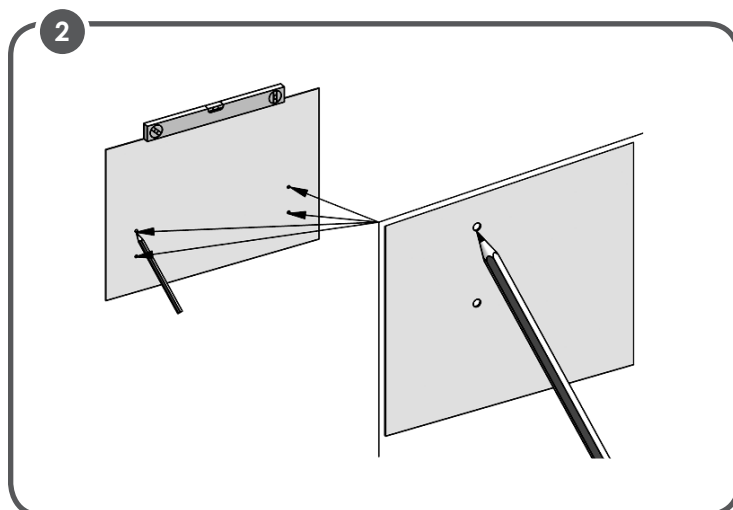
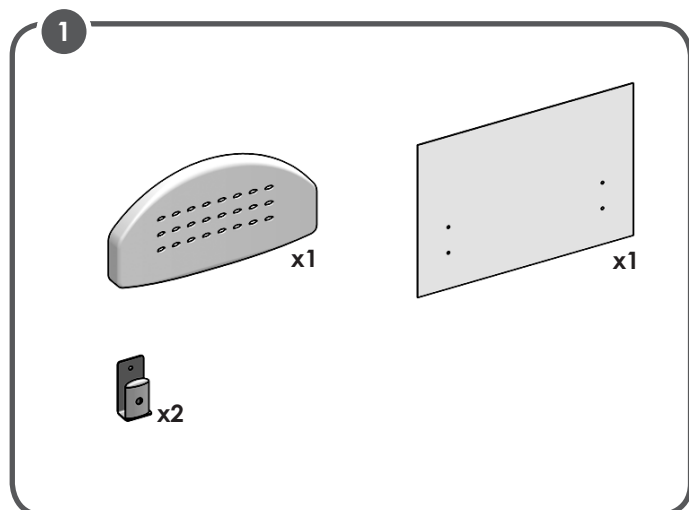

MADE IN ITALY

